

Series 280HTS Card Lok

CONNECT AND PROTECT



RECOMMENDED GAP WIDTH

- PCB + 10.29 mm (.405 in)

RECOMMENDED TORQUE

- 113 N-cm (10 in-lbs)
- With L Option: 158 N-cm (14 in-lbs)

WEIGHT

- 2.50 g/cm (.224 oz/in)

MATERIALS AND FINISH

BRACKETS AND FRONT WEDGE

- **Material :** 6061-T6 or T6XXX per ASTM-B221 or AMS-QQ-A-200/8
- **Finish :** See finish table on opposite page

SCREW AND WASHER

- **Material :** Stainless steel
- **Finish :** Passivated per AMS2700

THREADED INSERT

- **Material :** Stainless steel
- **Finish :** Passivated per AMS2700

PIN

- **Material :** Stainless steel
- **Finish :** Passivated per AMS2700

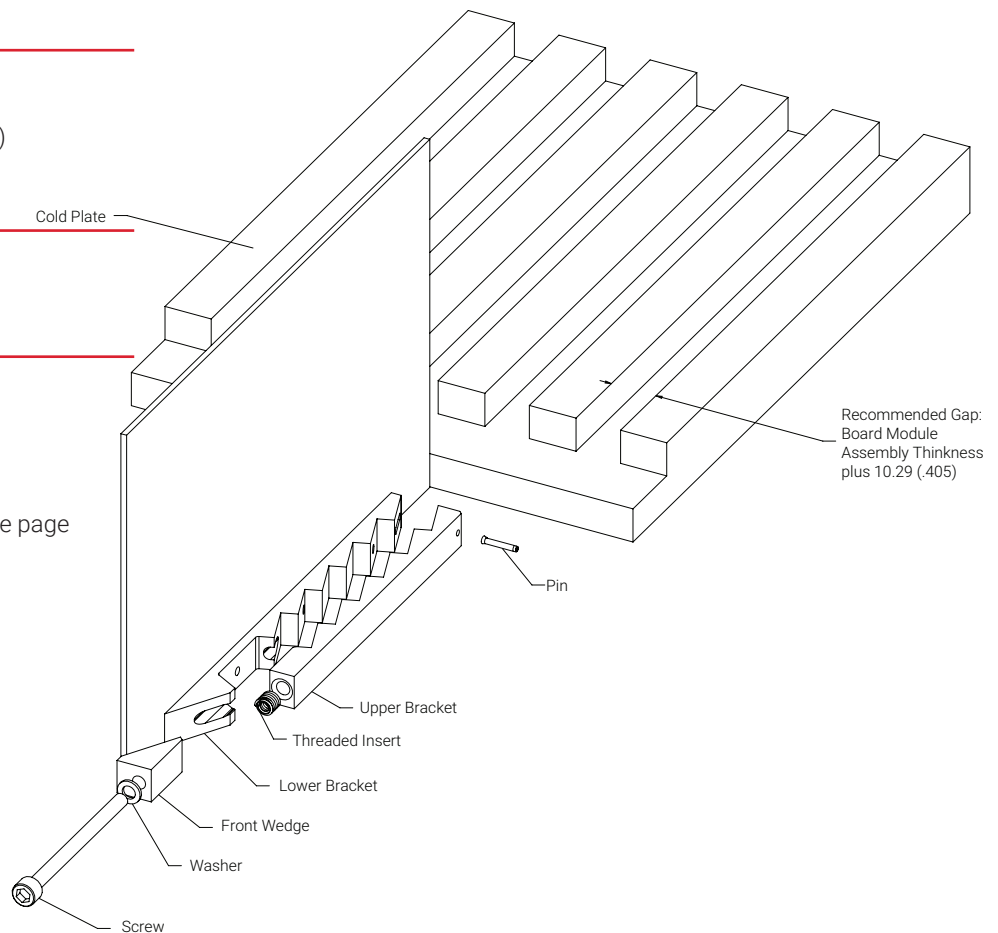

SERIES 280HTS CARD LOK

OPTIONS

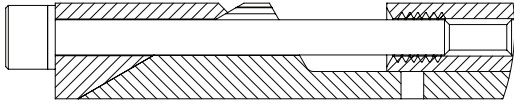

DETAIL "K" (RELAXED VIEW)

Detail "K"

Prevents the unintentional disassembly of screw from shaft.

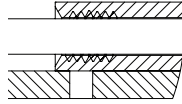

DETAIL "L" (RELAXED VIEW)

Detail "L"

SCREW LOCKING INSERT
Provides prevailing torque for resistance to loosening from shock and vibration. Meets NASM 8846.

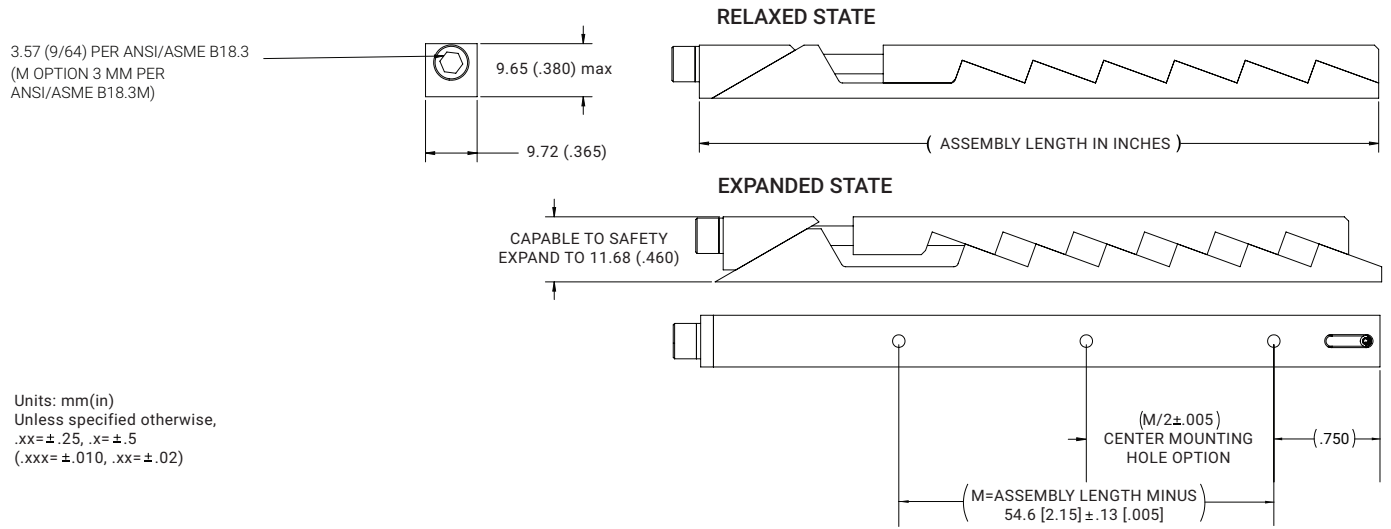

PART NUMBER CODE

	M	A	280HTS	-3.30	E	T4	L	K
Screw Drive								
Metric Screw Head M3 Hex Drive	M							
Standard Screw Head 9/64 Hex Drive	[Blank]							
Surface Finish								
Black Anodized	A							
Electroless Nickel	EN							
length								
Length in 12.7 (.50 increments)	83.82 (3.30)							
	to 325.12 (12.80)							
Mounting								
Additional Center Mounting Hole	E							
None	[Blank]							
Mounting Options - Mounting Holes or choose from Mounting Method Table	T4							
Threaded Insert								
Screw-Locking Insert	L							
Free-Running Insert	[Blank]							
Screw Type								
Captive Screw	K							
Standard	[Blank]							

PART NUMBER CODE EXAMPLE

M A 280HTS-4.80 E TM3 L K
Series 280HTS Card Lok with M3 hex drive, black anodized finish, 121.9 (4.80) long, with additional mounting hole, M3X0.50 tapped hole, locking insert and captive screw

FINISH TABLE

CODE	SURFACE FINISH
A	BLACK ANODIZE PER MIL-A-8625 TYPE II, CLASS 2
EN	ELECTROLESS NICKEL PER MIL-C-26074 CLASS 4, GRADE B, BRIGHT

MOUNTING METHOD TABLE

CODE	METHOD
"T4"	4-40 TAPPED HOLE
"TM3"	M3 X 0.50 TAPPED HOLE



Our powerful portfolio of brands:

CADDY ERICO HOFFMAN RAYCHEM SCHROFF TRACER